

# Feb Kit B

## Let's Make Beautiful Things Together

Just some info: ADHERE means to stick your card elements together using a tape runner, a double sided tape, a liquid craft glue or any combination of those. If I specify a type of adhesive, that's because the situation will work BEST using the recommended adhesive. But you can always just use what you have!



## Where to Start?

First confirm you have all card elements and pre-plan your card layout. Just to get an idea of how you want it to look.

## Contents:

- 1 Navy card base
- 1 Navy frame panel, with splatter
- 1 Set of cake die cuts
- 3 Brown panels
- 1 Peach panel
- Foam strips
- 1 Mailing liner  
(mailing liner only needed if you mail your card)\*\*
- 1 Coordinating envelope\*



## Let's Begin!

We'll construct the card front first.

You'll need the navy frame panel, the set of cake die cuts (not the hooray) and the foam strips (adhesive on both sides).

1. The cake is made up of the main section and the pull out piece. The main section has a white backer and a floral blue top piece. The pull out piece also has a white backer and a floral blue top piece. Adhere the floral blue pronged piece to the white backer with the pop out tabs. Place glue along the back of the floral blue piece to adhere it. See example picture. Now, using small dots of liquid glue, adhere the black frame to the pierced panel making sure to leave an even border along each edge.
2. Now, adhere the three word pieces in place so that it reads Oh Happy Day. DO NOT add glue onto the folding tabs.
3. Next, pop out the tabs so that they fold towards the back. These tabs will fit into the sliding slots on the main cake section backer. Insert the tabs into the slots and the fold them back flat. DO NOT glue these down. They allow the slice to slide back and forth. See example picture.
4. Next, with the slice piece already in place, adhere the large floral blue piece to the large white backer piece only adding glue to the left side of the centerline. See example picture. Move the slice in and out to confirm everything works properly.
5. Add an icing edging to the top and bottom of both the main section, and the slice of the cake. See example picture for placement ideas. Make sure they don't interfere with the slide.
6. Now adhere the small flower to the large flower. Add it to the cake, along with the peach leaves for added decoration. See example picture for placement ideas. Make sure they don't interfere with the slide.
7. The final piece of the cake is the "pull here" tab. Add glue to the lower section only and set the words just over the edge. See example picture for placement ideas.
8. To construct the cake stand adhere the silver oval to the top edge of the cake plate. It should align along the top edge. Next adhere the other silver stand piece along the top edge of the base. See example picture.
9. Adhere the bottom edge of the constructed cake to the top edge of the cake stand. See example picture for placement ideas.
10. Use the cake to measure proper placement of the candles and adhere them in place. Use small dots of glue and add the glitter flames to the candles.
11. Add foam strips to the back of the cake/stand and adhere it to the navy frame panel to create the card front.
12. (Optional) To add more dimension to the card, adhere the 3 brown panels to each other and add them to the back of the card front.
13. Adhere the card front to the card base making sure to leave an even border of navy showing along each edge.

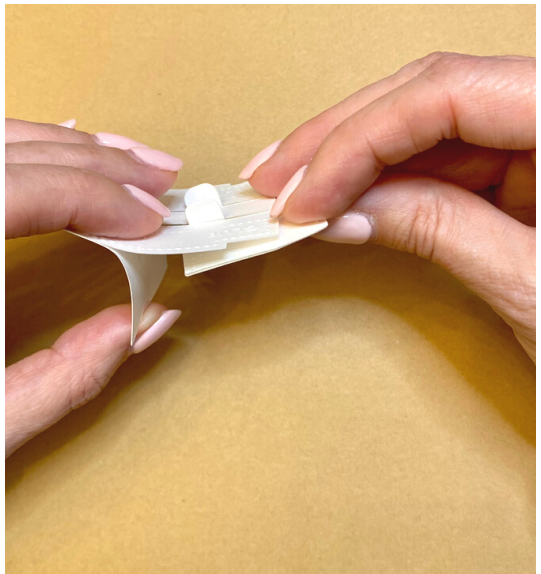
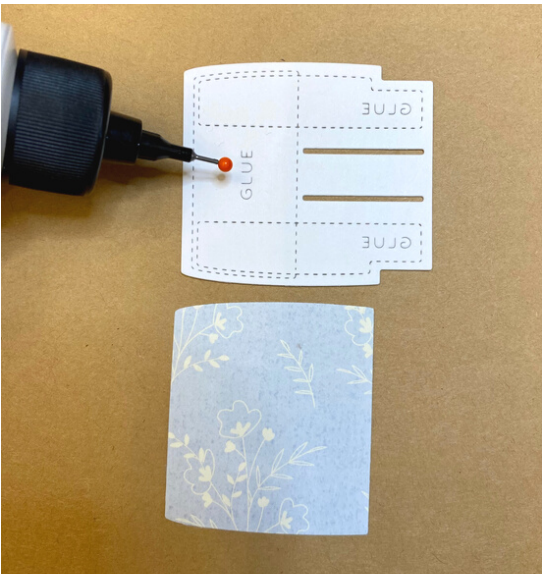
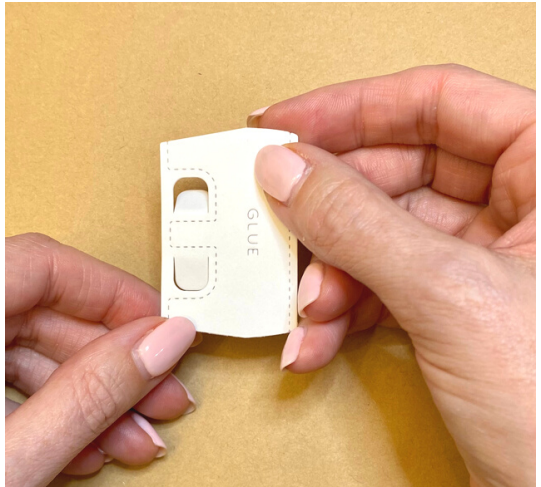
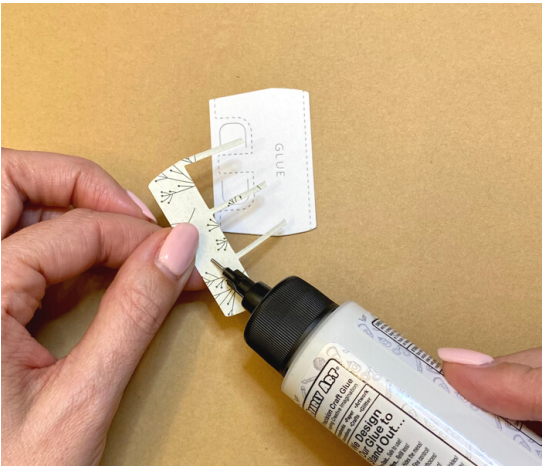

**That's it! Now let's decorate the inside of the card.**

1. Adhere the peach panel to the inside of the card base making sure to leave an even border of navy showing along each edge.
2. For decoration, adhere the Hooray die cut to the peach panel.



**And you did it!**

**Thank you so much for crafting with me!  
Don't forget to use the hashtag #sandiscardscreations on  
instagram to share your finished product and be featured  
in my story!**

**All instructions can be found on the Card Kit  
Instructions page at [sandiscards.com](http://sandiscards.com)**

**\*Confirm postage needed when mailing  
\*\*mailing liner is used as a barrier over the card front to protect it during  
shipping**